

# ROTOCLAMP OUTSIDE XL STANDARD



Size	D1 opened rated pressure  Pn = 4 bar	Required shaft diameter	D2	D3	B	E	F	n Number of fixing screws	a	t1	t2	Elastic holding torque Pn 4 bar  at 0 bar	Elastic holding torque Pn = 4 bar  Booster at 4 bar	Mass max.	Air requirement per stroke max.
Unit	[mm]	[mm]	[mm]	[mm]	[mm]	[mm]	[mm]	Quantity	[mm]	[°]	[°]	[Nm]	[Nm]	[kg]	[mL]
Tolerance	-0.04/-0.055	+0.01/+0.03	± 0.1		+0.4										
Roundness	0.01	0.01													
Surface finish	R <sub>a</sub> 0.8 μm	R <sub>a</sub> 0.8 μm													
RCO 520 XL	520	520	365	340	30	182.5	182.5	24xM8	8	15	15	3900	6500	22	30

When ordering, please specify »with or without booster«. Technical data applies to RotoClamp Inside L Active.

Holding torque for tandem version: Values factor 1.8. Subject to changes and errors, the respective written order confirmation applies.

# ROTOCLAMP OUTSIDE XL STANDARD

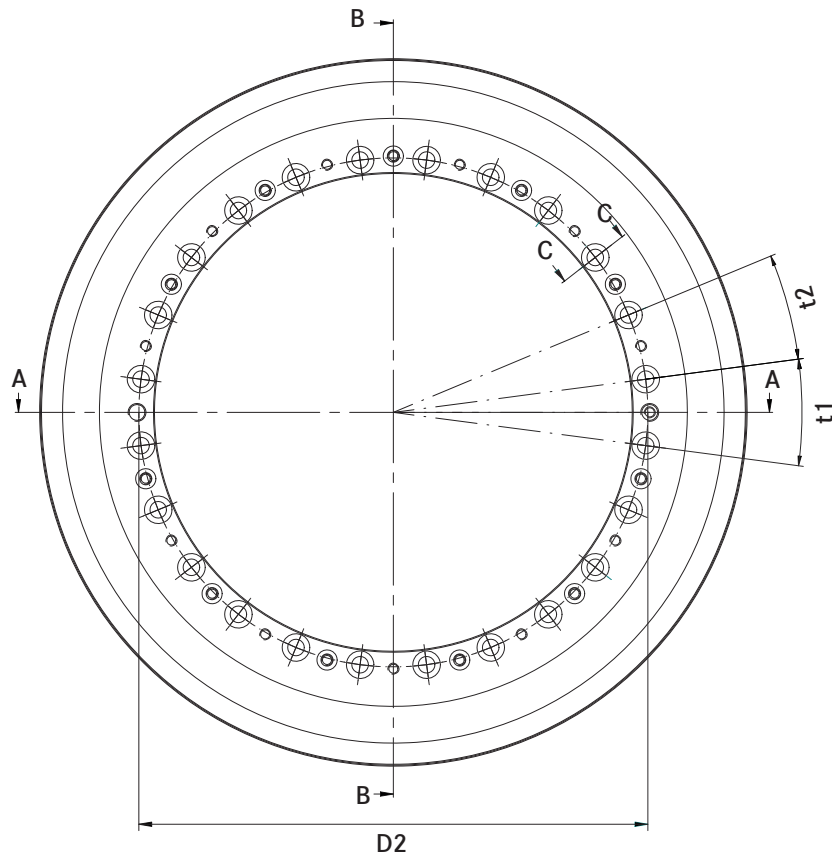

**Profile A-A**



**Profile B-B**

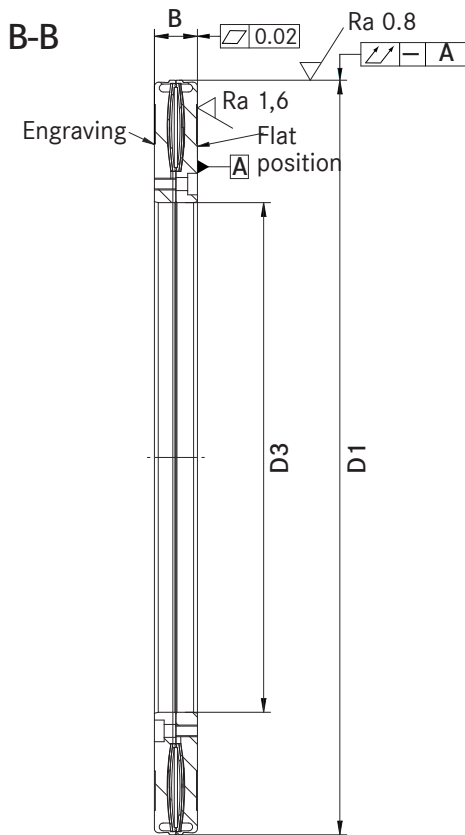

**Profile C-C**

