

Index

Inquiry-/Order-Sheets

ELASTIC/SAMURAI/LAMINAT Bellows Sheet 1	Page 2
ELASTIC/SAMURAI/LAMINAT Bellows Sheet 2	Page 3
ELASTIC/SAMURAI/LAMINAT Bellows Sheet 3	Page 4
ELASTIC/SAMURAI/LAMINAT Bellows Sheet 4	Page 5
ELASTIC/SAMURAI/LAMINAT Bellows Sheet 5	Page 6
ELASTIC/SAMURAI/LAMINAT Bellows Sheet 6	Page 7
ELASTIC/SAMURAI/LAMINAT Venetian Blinds	Page 8
SAMURAI-FASTLAP	Page 9
ELASTIC-/SAMURAI Bellows for Elevating Tables	Page 10
LAMINAT Polyagonal Bellows Sheet 1	Page 11
LAMINAT Polyagonal Bellows Sheet 2	Page 12
Round-stitched Bellows	Page 13
SPEZIAL Bellows	Page 14
DURASPRING Spiral Springs	Page 15
Roller Covers/Apron Covers	Page 16
Roller Covers with Enclosures with/without Apron Covers	Page 17
GLADIATOR Telescopic Steel Covers (TSC) Sheet 1	Page 18
GLADIATOR Telescopic Steel Covers (TSC) Sheet 2	Page 19
GLADIATOR Telescopic Steel Covers (TSC) Sheet 3	Page 20
Wiper Systems	Page 21
VISIPOINT Spin Window Systems	Page 22
Machine Safety Windows made of Polycarbonate	Page 23
EAGLEVISION integrated Spin Window Systems	Page 24

Inquiry-/Order-Sheet for ELASTIC/SAMURAI/LAMINAT Bellows

Sheet 1



Company name: Company stamp:

Contact person:

Phone: Fax:

Quantity: E-Mail:

Delivery date: Date: Signature:

Application/Type of machine: Year of make:

Seligenstädter Straße 82
D - 63500 Seligenstadt
Phone
00 49 - (0) 61 82 - 773 - 0

Send form to fax No.
00 49 - (0) 61 82 - 7 73 35

or via Internet:
www.hema-gmbh.com

Type of Construction: Thermically sealed Stitched

Type of Lamellas: Flexible Fixed Box design

Position of Lamellas: → Pos. 1 Pos. 2 Pos. 3

Guiding profile

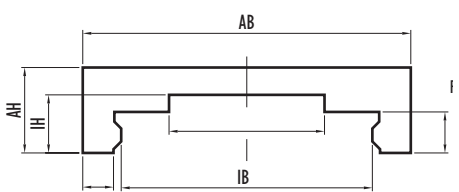

Assembly situation

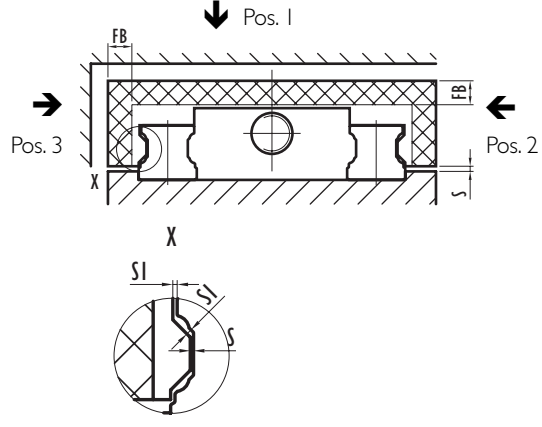

Guideway

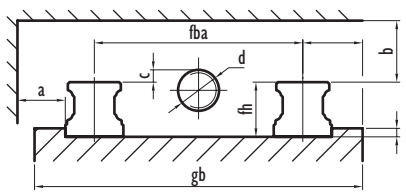

Mounting alternatives (examples):

Mounting flanges: Steel Stainless Steel Plastic

Thickness in mm

left side right side

Bellow dimensions:

Outside width	AB	= mm	Clearance	S	= mm
Inside width	IB	= mm	Clearance	SI	= mm
Outside height	AH	= mm	Extension	L max	= mm
Inside height	IH	= mm	Stroke		= mm
Fold width	FB	= mm	Compression	L min	= mm

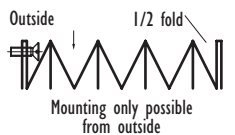

Mounting position:

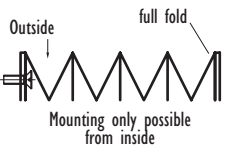
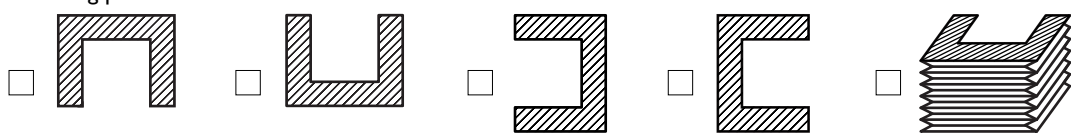

Machine dimensions:

Distance between guideway	fba	= mm	Available assembly space	b	= mm
Height of guideway	fh	= mm	Shaft diameter	d	= mm
Width of total way	gb	= mm	Dimension	c	= mm
Available assembly space	a	= mm				



Linear Guide: Manufacturer: Size: Type:

Operating conditions:

Indoor <input type="checkbox"/>	Coolant, type <input type="checkbox"/>	Heat <input type="checkbox"/>	Oil, type <input type="checkbox"/>
Outdoor <input type="checkbox"/>	Corrosive <input type="checkbox"/>	Welding sparks <input type="checkbox"/>	Heavy chips <input type="checkbox"/>
Wet <input type="checkbox"/>	Abrasive <input type="checkbox"/>	Ash/Dust/Sand <input type="checkbox"/>	Chips/Swarfs <input type="checkbox"/>
Dry <input type="checkbox"/>	Magnetic <input type="checkbox"/>	Salt water <input type="checkbox"/>	Vacuum <input type="checkbox"/>



Working temperatures: °C Speed of stroke: m/Min

Internal/External pressure: bar Frequency of operation: per

Please send CAD-files via email to: j.heberer@hema-schutz.de

Inquiry-/Order-Sheet for ELASTIC/SAMURAI/LAMINAT Bellows

Sheet 2



Company name: Company stamp:
 Contact person:
 Phone: Fax:
 Quantity: E-Mail:
 Delivery date: Date: Signature:
 Application/Type of machine: Year of make:

Seligenstädter Straße 82
 D-63500 Seligenstadt
 Phone
 0049-(0)6182-773-0

Send form to fax No.
 0049-(0)6182-77335

or via Internet:
www.hema-gmbh.com

Type of Construction: Thermally sealed Stitched
 Type of Lamellas: Flexible Fixed Box design
 Position of Lamellas: Pos. 1 Pos. 2 Pos. 3 Pos. 4 Pos. 5

Guiding profile

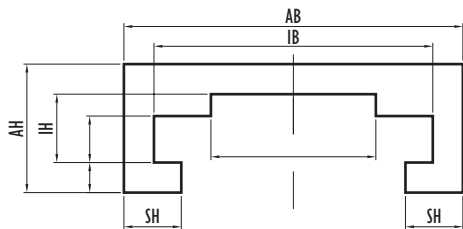

Assembly situation

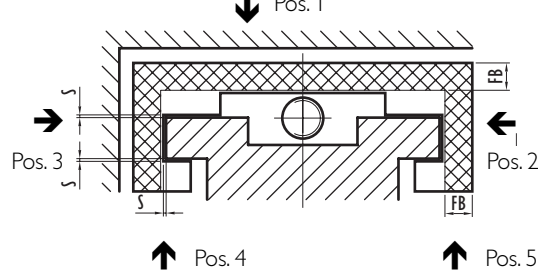

Guideway

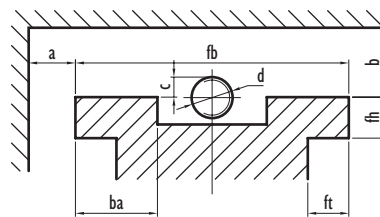

Bellow dimensions:

Outside width	AB =	mm	Fold width	FB =	mm
Inside width	IB =	mm	Clearance	S =	mm
Outside height	AH =	mm	Extension	L max =	mm
Inside height	IH =	mm	Stroke	=	mm
Width cover lower return	SH =	mm	Compression	L min =	mm

Mounting position:

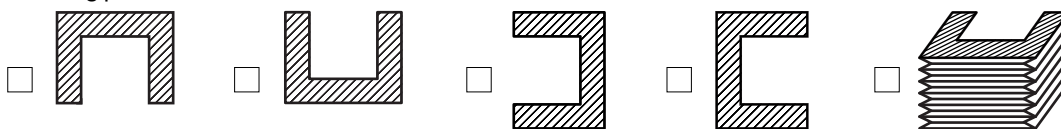

Machine dimensions:

Width of guideway	fb =	mm	Available assembly space	b =	mm
Height of guideway	fh =	mm	Width of guideway support	ba =	mm
Depth of guideway	gb =	mm	Shaft diameter	d =	mm
Available assembly space	a =	mm	Dimension	c =	mm

Operating conditions:

Indoor Outdoor Wet Dry
 Coolant, type Corrosive Abrasive Magnetic
 Heat Welding sparks Ash/Dust/Sand Salt water
 Oil, type Heavy chips Chips/Swarfs Vacuum

Working temperatures: °C Speed of stroke: m/Min
 Internal/External pressure: bar Frequency of operation: per

Released: 4/2002

Mounting alternatives (examples):

Mounting flanges: Steel Stainless Steel Plastic
 Thickness in mm

left side right side

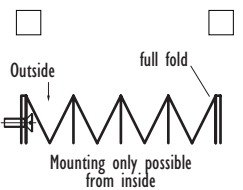
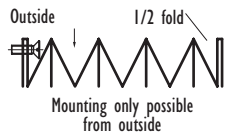

Please send CAD-files via email to: j.heberer@hema-schutz.de

Inquiry-/Order-Sheet for ELASTIC/SAMURAI/LAMINAT Bellows

Sheet 3



Company name: Company stamp:

Contact person:

Phone: Fax:

Quantity: E-Mail:

Delivery date: Date: Signature:

Application/Type of machine: Year of make:

Seligenstädter Straße 82
D - 63500 Seligenstadt
Phone
00 49 - (0) 61 82 - 773 - 0

Send form to fax No.
00 49 - (0) 61 82 - 7 73 35

or via Internet:
www.hema-gmbh.com

Type of Construction:

- Thermically sealed
Stitched

Type of Lamellas:

- Flexible
Fixed
Box design

Position of Lamellas: →

- Pos. 1 Pos. 3
Pos. 2 Pos. 4

Guiding profile

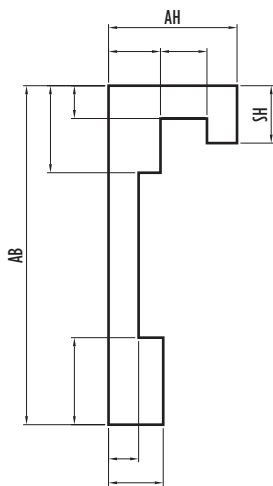

Assembly situation

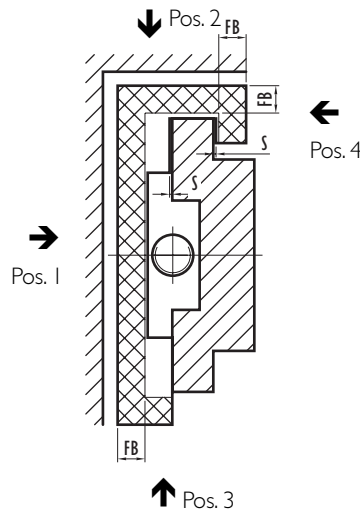

Guideway

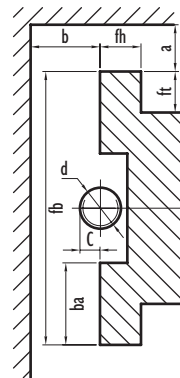

Mounting alternatives (examples):

- Mounting flanges:
Steel
Stainless Steel
Plastic
Thickness in mm

- left side right side

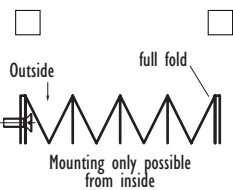
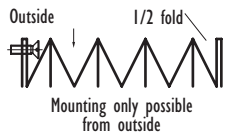

Bellow dimensions:

- | | | | | | |
|--------------------------|------------|----|-------------|---------------|----|
| Outside width | AB = | mm | Clearance | S = | mm |
| Outside height | AH = | mm | Extension | L max = | mm |
| Width cover lower return | SH = | mm | Stroke | = | mm |
| Fold width | FB = | mm | Compression | L min = | mm |

Mounting position:

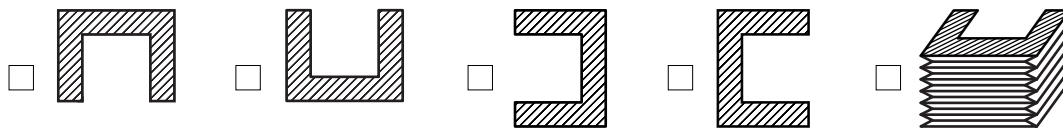

Machine dimensions:

- | | | | | | |
|--------------------------|------------|----|---------------------------|------------|----|
| Width of guideway | fb = | mm | Available assembly space | b = | mm |
| Height of guideway | fh = | mm | Width of guideway support | ba = | mm |
| Depth of guideway | ft = | mm | Shaft diameter | d = | mm |
| Available assembly space | a = | mm | Dimension | c = | mm |

Operating conditions:

- | | | | | | |
|----------------------------------|------------------------------------|--------------------------|---|---------------------------------------|--------------------------|
| Indoor <input type="checkbox"/> | Coolant, type | <input type="checkbox"/> | Heat <input type="checkbox"/> | Oil, type | <input type="checkbox"/> |
| Outdoor <input type="checkbox"/> | Corrosive <input type="checkbox"/> | <input type="checkbox"/> | Welding sparks <input type="checkbox"/> | Heavy chips <input type="checkbox"/> | <input type="checkbox"/> |
| Wet <input type="checkbox"/> | Abrasive <input type="checkbox"/> | <input type="checkbox"/> | Ash/Dust/Sand <input type="checkbox"/> | Chips/Swarfs <input type="checkbox"/> | <input type="checkbox"/> |
| Dry <input type="checkbox"/> | Magnetic <input type="checkbox"/> | <input type="checkbox"/> | Salt water <input type="checkbox"/> | Vacuum <input type="checkbox"/> | <input type="checkbox"/> |

- Working temperatures: °C Speed of stroke: m/Min
Internal/External pressure: bar Frequency of operation: per

Please send CAD-files
via email to:
j.heberer@hema-schutz.de

Inquiry-/Order-Sheet for ELASTIC/SAMURAI/LAMINAT Bellows

Sheet 4



Company name: Company stamp:
 Contact person:
 Phone: Fax:
 Quantity: E-Mail:
 Delivery date: Date: Signature:
 Application/Type of machine: Year of make:

Seligenstädter Straße 82
 D-63500 Seligenstadt
 Phone
 0049-(0)6182-773-0

Send form to fax No.
 0049-(0)6182-77335

or via Internet:
www.hema-gmbh.com

Type of Construction: Thermically sealed Stitched
 Type of Lamellas: Flexible Fixed Box design
 Position of Lamellas: → Pos. 1 Pos. 2 Pos. 3 Pos. 4 Pos. 5

Guiding profile

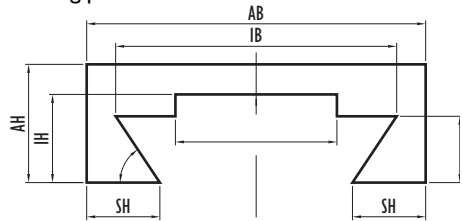

Assembly situation

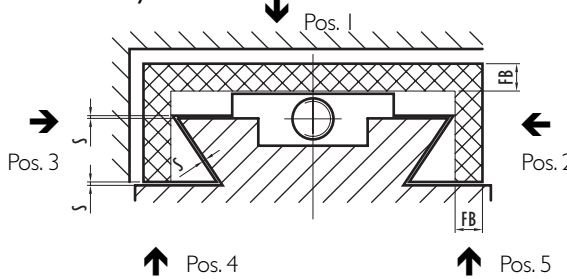

Guideway

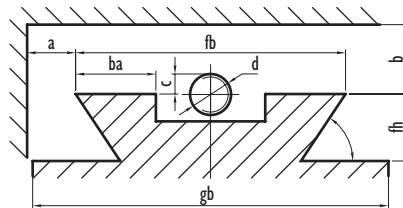

Mounting alternatives (examples):

Mounting flanges: Steel Stainless Steel Plastic
 Thickness in mm

left side right side

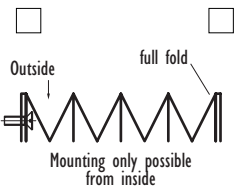
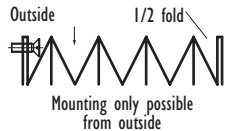

Bellow dimensions:

Outside width	AB =	mm	Fold width	FB =	mm
Inside width	IB =	mm	Clearance	S =	mm
Outside height	AH =	mm	Extension	L max =	mm
Inside height	IH =	mm	Stroke	=	mm
Width cover lower return	SH =	mm	Compression	L min =	mm

Mounting position:

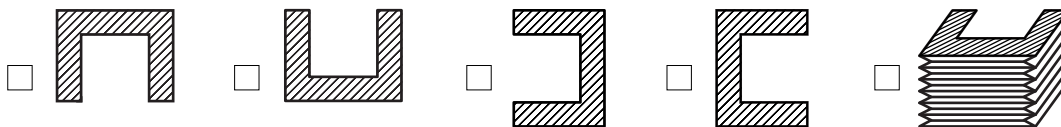

Machine dimensions:

Width of guideway	fb =	mm	Available assembly space	b =	mm
Height of guideway	fh =	mm	Width of guideway support	ba =	mm
Depth of guideway	ft =	mm	Shaft diameter	d =	mm
Available assembly space	a =	mm	Dimension	c =	mm

Operating conditions:

Indoor <input type="checkbox"/>	Coolant, type <input type="checkbox"/>	Heat <input type="checkbox"/>	Oil, type <input type="checkbox"/>
Outdoor <input type="checkbox"/>	Corrosive <input type="checkbox"/>	Welding sparks <input type="checkbox"/>	Heavy chips <input type="checkbox"/>
Wet <input type="checkbox"/>	Abrasive <input type="checkbox"/>	Ash/Dust/Sand <input type="checkbox"/>	Chips/Swarfs <input type="checkbox"/>
Dry <input type="checkbox"/>	Magnetic <input type="checkbox"/>	Salt water <input type="checkbox"/>	Vacuum <input type="checkbox"/>

Working temperatures: °C Speed of stroke: m/Min
 Internal/External pressure: bar Frequency of operation: per

Please send CAD-files via email to: j.heberer@hema-schutz.de

Inquiry-/Order-Sheet for ELASTIC/SAMURAI/LAMINAT Bellows

Sheet 5



Company name: Company stamp:
 Contact person:
 Phone: Fax:
 Quantity: E-Mail:
 Delivery date: Date: Signature:
 Application/Type of machine: Year of make:

Seligenstädter Straße 82
 D - 63500 Seligenstadt
 Phone
 00 49 - (0) 61 82 - 773 - 0

Send form to fax No.
 00 49 - (0) 61 82 - 7 73 35

or via Internet:
www.hema-gmbh.com

Type of Construction: Thermally sealed Stitched
 Type of Lamellas: Flexible Fixed Box design
 Position of Lamellas: → Pos. 1 Pos. 2 Pos. 3

Guiding profile

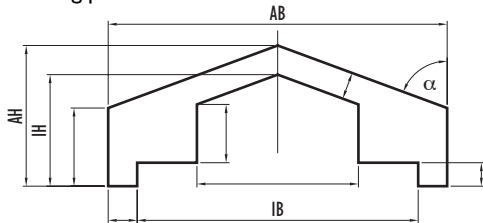

Assembly situation

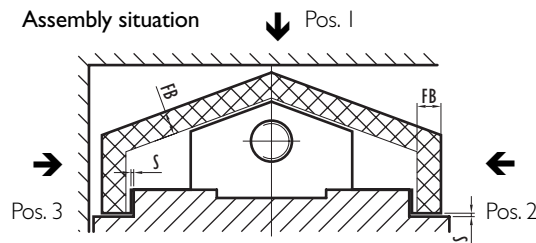

Guideway

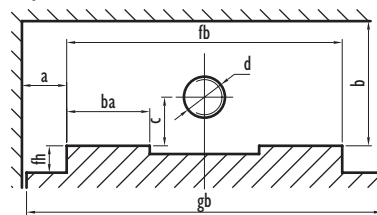

Bellow dimensions:

Outside width	AB	= mm	Fold width	FB	= mm
Inside width	IB	= mm	Clearance	S	= mm
Outside height	AH	= mm	Extension	L max	= mm
Inside height	IH	= mm	Stroke		= mm
Width cover lower return	SH	= mm	Compression	L min	= mm
Angle of inclination	α	= °				

Mounting position:

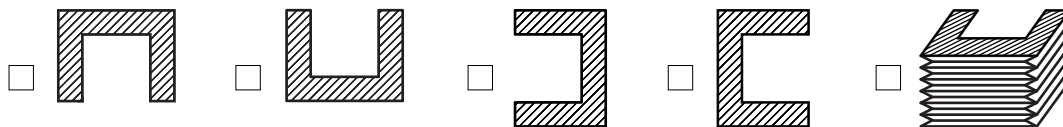

Machine dimensions:

Width of guideway	fb	= mm	Available assembly space	b	= mm
Height of guideway	fh	= mm	Width of guideway support	ba	= mm
Depth of guideway	ft	= mm	Shaft diameter	d	= mm
Available assembly space	a	= mm	Dimension	c	= mm

Operating conditions:

Indoor <input type="checkbox"/>	Coolant, type <input type="checkbox"/>	Heat <input type="checkbox"/>	Oil, type <input type="checkbox"/>
Outdoor <input type="checkbox"/>	Corrosive <input type="checkbox"/>	Welding sparks <input type="checkbox"/>	Heavy chips <input type="checkbox"/>
Wet <input type="checkbox"/>	Abrasive <input type="checkbox"/>	Ash/Dust/Sand <input type="checkbox"/>	Chips/Swarfs <input type="checkbox"/>
Dry <input type="checkbox"/>	Magnetic <input type="checkbox"/>	Salt water <input type="checkbox"/>	Vacuum <input type="checkbox"/>

Working temperatures: °C Speed of stroke: m/Min
 Internal/External pressure: bar Frequency of operation: per

Mounting alternatives (examples):

Mounting flanges: Steel Stainless Steel Plastic
 Thickness in mm

left side right side

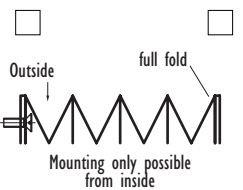
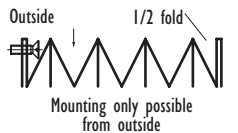

Please send CAD-files via email to: j.heberer@hema-schutz.de

Inquiry-/Order-Sheet for ELASTIC/SAMURAI/LAMINAT Bellows

Sheet 6



Company name: Company stamp:

Contact person:

Phone: Fax:

Quantity: E-Mail:

Delivery date: Date: Signature:

Application/Type of machine: Year of make:

Seligenstädter Straße 82
D-63500 Seligenstadt
Phone
00 49 - (0) 61 82 - 773 - 0

Send form to fax No.
00 49 - (0) 61 82 - 7 73 35

or via Internet:
www.hema-gmbh.com

Type of Construction: Thermically sealed Stitched

Type of Lamellas: Flexible Fixed Box design

Position of Lamellas: → Pos. 1 Pos. 2 Pos. 3

Guiding profile

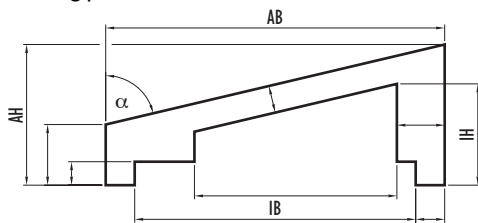

Assembly situation

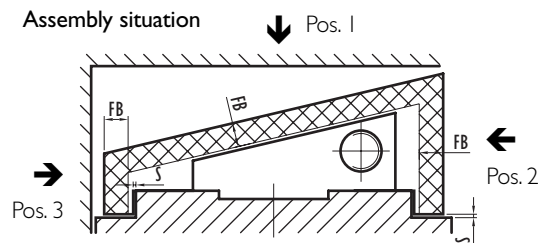

Guideway

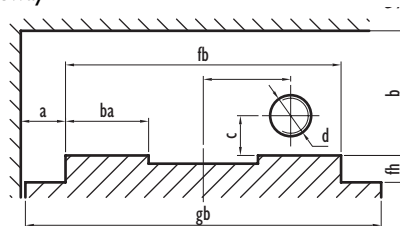

Mounting alternatives (examples):

Mounting flanges: Steel Stainless Steel Plastic

Thickness in mm

left side right side

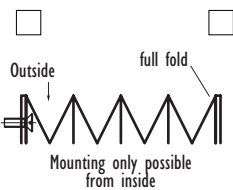
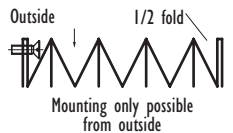

Bellow dimensions:

Outside width	AB =	mm	Fold width	FB =	mm
Inside width	IB =	mm	Clearance	S =	mm
Outside height	AH =	mm	Extension	L max =	mm
Inside height	IH =	mm	Stroke	=	mm
Angle of inclination	α =	°	Compression	L min =	mm

Mounting position:

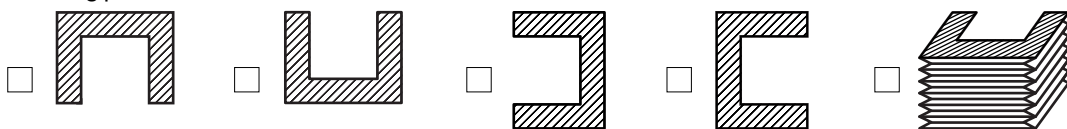

Machine dimensions:

Width of guideway	fb =	mm	Available assembly space	b =	mm
Height of guideway	fh =	mm	Width of guideway support	ba =	mm
Depth of guideway	gb =	mm	Shaft diameter	d =	mm
Available assembly space	a =	mm	Dimension	c =	mm

Operating conditions:

Indoor <input type="checkbox"/>	Coolant, type <input type="checkbox"/>	Heat <input type="checkbox"/>	Oil, type <input type="checkbox"/>
Outdoor <input type="checkbox"/>	Corrosive <input type="checkbox"/>	Welding sparks <input type="checkbox"/>	Heavy chips <input type="checkbox"/>
Wet <input type="checkbox"/>	Abrasive <input type="checkbox"/>	Ash/Dust/Sand <input type="checkbox"/>	Chips/Swarfs <input type="checkbox"/>
Dry <input type="checkbox"/>	Magnetic <input type="checkbox"/>	Salt water <input type="checkbox"/>	Vacuum <input type="checkbox"/>

Working temperatures: °C Speed of stroke: m/Min

Internal/External pressure: bar Frequency of operation: per

Please send CAD-files via email to: j.heberer@hema-schutz.de

Inquiry-/Order-Sheet for ELASTIC/SAMURAI/LAMINAT Venetian Blinds



Company name: Company stamp:

Contact person:

Phone: Fax:

Quantity: E-Mail:

Delivery date: Date: Signature:

Application/Type of machine: Year of make:

Seligenstädter Straße 82
D - 63500 Seligenstadt
Phone
00 49 - (0) 61 82 - 773 - 0

Send form to fax No.
00 49 - (0) 61 82 - 7 73 35

or via Internet:
www.hema-gmbh.com

Type of construction for Venetian blinds:

Thermally sealed Both sides stitched
Upper side stitched With plastic frames

Type of Lamellas for Venetian blinds:

Flexible
Fixed

Guiding profiles (optional)

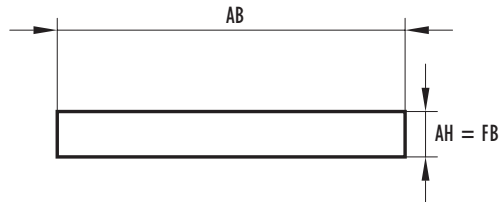

Guideway

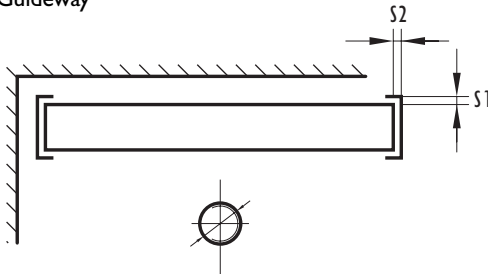

Mounting position:

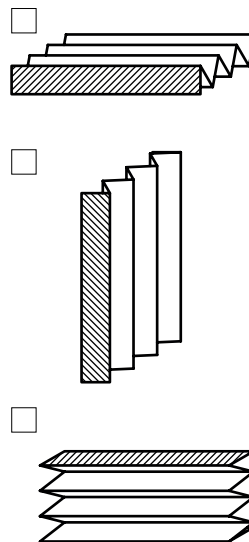

Mounting alternatives (examples):

Mounting flanges:

Steel
Stainless Steel
Plastic
Thickness in mm

left side right side

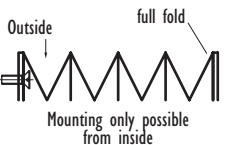
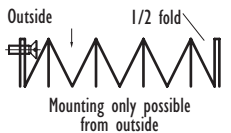

Bellow dimensions:

Outside width	AB	= mm	Extension	L max	= mm
Outside height	AH	= mm	Stroke		= mm
Fold width	FB	= mm	Compression	L min	= mm
Space required for lamella overlap	X	= mm	Clearance	S1/S2	= mm

Operating conditions:

Indoor	<input type="checkbox"/>	Coolant, type	<input type="checkbox"/>	Heat	<input type="checkbox"/>	Oil, type	<input type="checkbox"/>
Outdoor	<input type="checkbox"/>	Corrosive	<input type="checkbox"/>	Welding sparks	<input type="checkbox"/>	Heavy chips	<input type="checkbox"/>
Wet	<input type="checkbox"/>	Abrasive	<input type="checkbox"/>	Ash/Dust/Sand	<input type="checkbox"/>	Chips/Swarfs	<input type="checkbox"/>
Dry	<input type="checkbox"/>	Magnetic	<input type="checkbox"/>	Salt water	<input type="checkbox"/>	Vacuum	<input type="checkbox"/>

Working temperatures: °C Speed of stroke: m/Min
Internal/External pressure: bar Frequency of operation: per

Please send CAD-files via email to: j.heberer@hema-schutz.de

Inquiry-/Order-Sheet for SAMURAI-FASTLAP



Company name: Company stamp:

Contact person:

Phone: Fax:

Quantity: E-Mail:

Delivery date: Date: Signature:

Application/Type of machine: Year of make:

Seligenstädter Straße 82
D - 63500 Seligenstadt
Phone
00 49 - (0) 61 82 - 773 - 0

Send form to fax No.
00 49 - (0) 61 82 - 7 73 35

or via Internet:
www.hema-gmbh.com

Type of Lamellas for Venetian blinds: FASTLAP FASTLAP SA FASTLAP SB

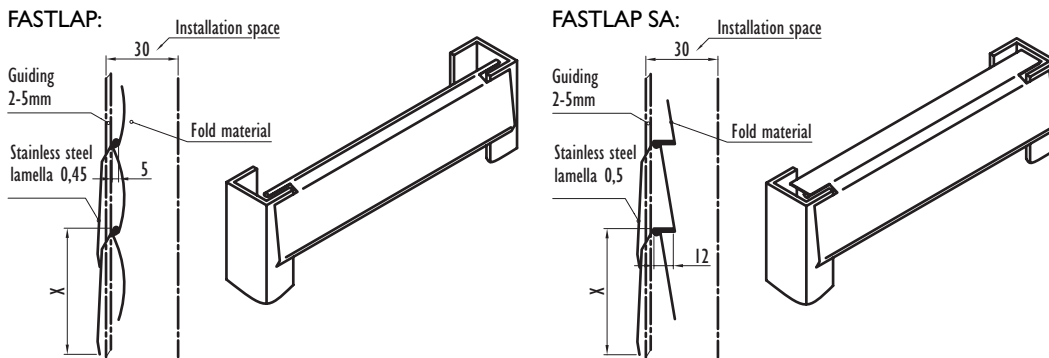

Top View FASTLAP und FASTLAP SA:

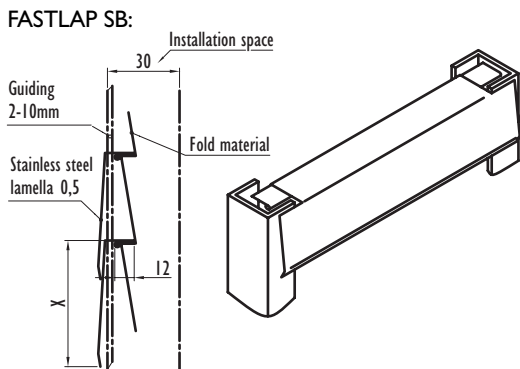
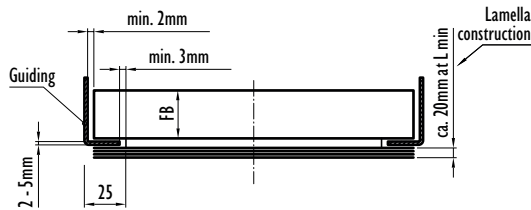

Top View FASTLAP SB:

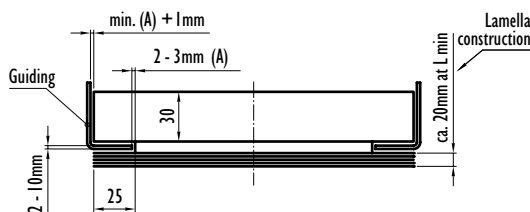

Bellow dimensions:

Outside width	AB =	mm	Extension	L max =	mm
Outside height	AH =	mm	Stroke	=	mm
Fold width	FB =	mm	Compression	L min =	mm
Space required for lamella overlap	X =	mm	Clearance	S1/S2 =	mm

Operating conditions:

Indoor	<input type="checkbox"/>	Coolant, type	<input type="checkbox"/>	Heat	<input type="checkbox"/>	Oil, type	<input type="checkbox"/>
Outdoor	<input type="checkbox"/>	Corrosive	<input type="checkbox"/>	Welding sparks	<input type="checkbox"/>	Heavy chips	<input type="checkbox"/>
Wet	<input type="checkbox"/>	Abrasive	<input type="checkbox"/>	Ash/Dust/Sand	<input type="checkbox"/>	Chips/Swarfs	<input type="checkbox"/>
Dry	<input type="checkbox"/>	Magnetic	<input type="checkbox"/>	Salt water	<input type="checkbox"/>	Vacuum	<input type="checkbox"/>

Working temperatures: °C Speed of stroke: m/Min
Internal/External pressure: bar Frequency of operation: per

Released: 11/2006

Mounting alternatives (examples):

Mounting flanges:
Steel
Stainless Steel
Plastic
Thickness in mm

left side right side

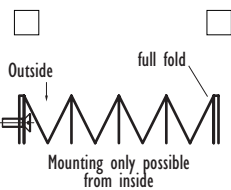
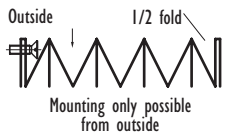

Please send CAD-files via email to: j.heberer@hema-schutz.de

Inquiry-/Order-Sheet for ELASTIC/SAMURAI Bellows for Elevating Tables



Company name: Company stamp:

Contact person:

Phone: Fax:

Quantity: E-Mail:

Delivery date: Date: Signature:

Replacement Application, Maker of Elevating Table, Type:

Split Design

Seligenstädter Straße 82
D - 63500 Seligenstadt
Phone
00 49 - (0) 61 82 - 773 - 0

Send form to fax No.
00 49 - (0) 61 82 - 7 73 35

or via Internet:
www.hema-gmbh.com

Type of Construction: Thermically sealed Stitched

Type of Lamellas: Flexible Fixed Box design

Position of Lamellas: → Pos. 1 Pos. 2 Pos. 3 Pos. 4

Mounting alternatives (examples):

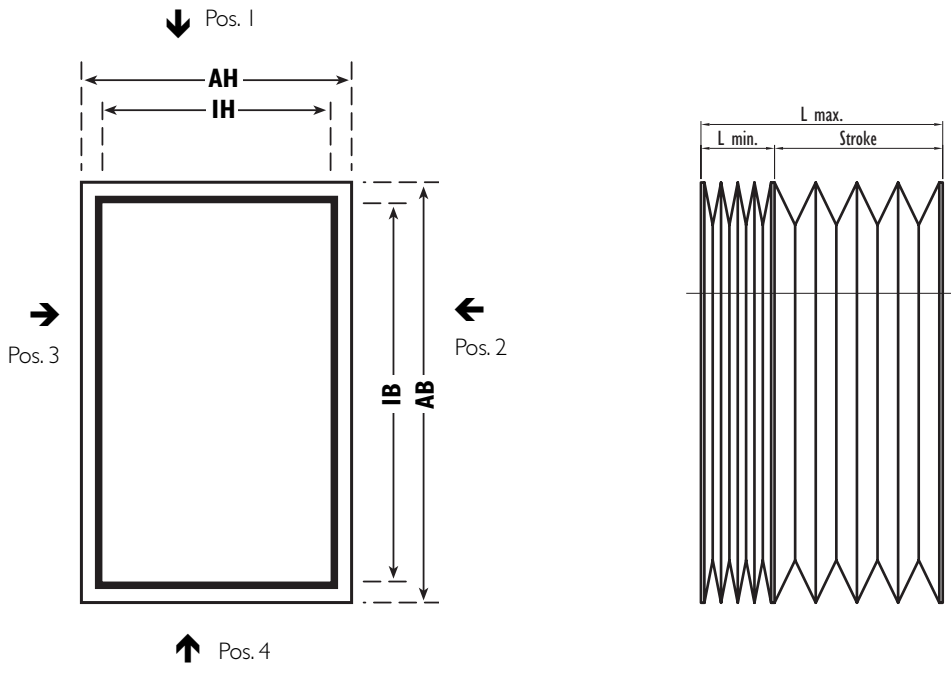

Mounting flanges: Steel Stainless Steel Plastic Thickness in mm

left side right side

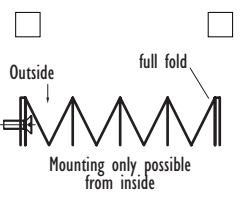
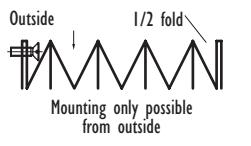

Bellow dimensions:

Outside width	AB =	mm	Extension	L max =	mm
Inside width	IB =	mm	Stroke	=	mm
Outside height	AH =	mm	Compression	L min =	mm
Inside height	IH =	mm			
Fold width	FB =	mm			

Mounting position: horizontal vertical Angle (if different)°

Operating conditions:

Indoor <input type="checkbox"/>	Coolant, type	<input type="checkbox"/>	Heat <input type="checkbox"/>	Oil, type	<input type="checkbox"/>
Outdoor <input type="checkbox"/>	Corrosive <input type="checkbox"/>		Welding sparks <input type="checkbox"/>	Heavy chips <input type="checkbox"/>	
Wet <input type="checkbox"/>	Abrasive <input type="checkbox"/>		Ash/Dust/Sand <input type="checkbox"/>	Chips/Swarfs <input type="checkbox"/>	
Dry <input type="checkbox"/>	Magnetic <input type="checkbox"/>		Salt water <input type="checkbox"/>	Vacuum <input type="checkbox"/>	

Working temperatures: °C Speed of stroke: m/Min
Internal/External pressure: bar Frequency of operation: per

Please send CAD-files via email to: j.heberer@hema-schutz.de

Inquiry-/Order-Sheet for LAMINAT Polyagonal Bellows

Sheet I



Seligenstädter Straße 82
D-63500 Seligenstadt
Phone
0049-(0)6182-773-0

Send form to fax No.
0049-(0)6182-77335

or via Internet:
www.hema-gmbh.com

Company name: Company stamp:

Contact person:

Phone: Fax:

Quantity: E-Mail:

Delivery date: Date: Signature:

Application/Type of machine: Year of make:

Retrofit installation Split Design

For **standard shapes** please use the "ELASTIC/SAMURAI/LAMINAT Bellows" sheets.

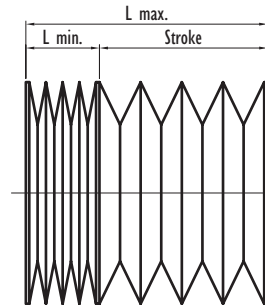
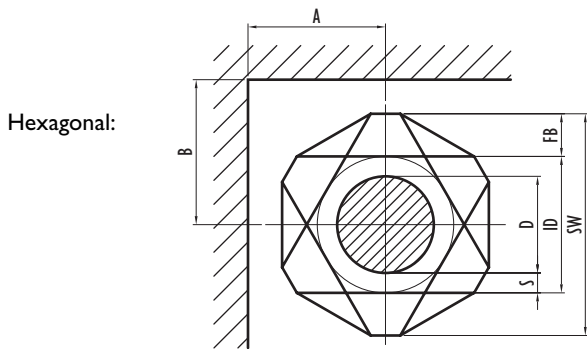

Mounting possibilities:

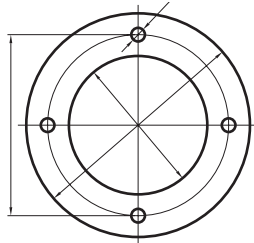

Flange

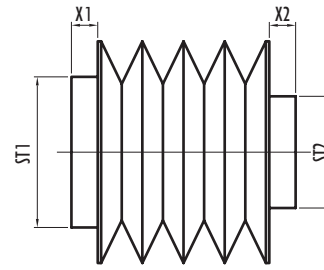

Sleeve

Mounting alternatives (examples):

- Mounting flanges:
- Steel
 - Stainless Steel
 - Plastic
 - Thickness in mm

left side right side

- Mounting with Flange
- Mounting with Sleeve
- Mounting with Strap Retainer

Bellow dimensions:

Width of bellow	SW =	mm	Diameter of sleeve	ST1 =	mm
Inner diameter	ID =	mm	Diameter of sleeve	ST2 =	mm
Fold width	FB =	mm	Extension	L max =	mm
Width of sleeve	X1 =	mm	Stroke	=	mm
Width of sleeve	X2 =	mm	Compression	L min =	mm



Mounting position: horizontal vertical Angle (if different)°

Machine dimensions:

Shaft diameter	D =	mm	Available assembly space	A =	mm
Pitch	=	mm	Available assembly space	B =	mm
			Clearance (min. mm)	S =	mm



Operating conditions:

- | | | | | | |
|----------------------------------|------------------------------------|--------------------------|---|---------------------------------------|--------------------------|
| Indoor <input type="checkbox"/> | Coolant, type | <input type="checkbox"/> | Heat <input type="checkbox"/> | Oil, type | <input type="checkbox"/> |
| Outdoor <input type="checkbox"/> | Corrosive <input type="checkbox"/> | | Welding sparks <input type="checkbox"/> | Heavy chips <input type="checkbox"/> | |
| Wet <input type="checkbox"/> | Abrasive <input type="checkbox"/> | | Ash/Dust/Sand <input type="checkbox"/> | Chips/Swarfs <input type="checkbox"/> | |
| Dry <input type="checkbox"/> | Magnetic <input type="checkbox"/> | | Salt water <input type="checkbox"/> | Vacuum <input type="checkbox"/> | |

Working temperatures: °C Speed of stroke: m/Min
Internal/External pressure: bar Frequency of operation: per

Please send CAD-files via email to: j.heberer@hema-schutz.de

Inquiry-/Order-Sheet for LAMINAT Polyagonal Bellows

Sheet 2



Company name: Company stamp:

Contact person:

Phone: Fax:

Quantity: E-Mail:

Delivery date: Date: Signature:

Application/Type of machine: Year of make:

Seligenstädter Straße 82
D-63500 Seligenstadt
Phone
00 49 - (0) 61 82 - 773 - 0

Send form to fax No.
00 49 - (0) 61 82 - 7 73 35

or via Internet:
www.hema-gmbh.com

Retrofit installation Split Design

For **standard shapes** please use the "ELASTIC/SAMURAI/LAMINAT Bellows" sheets.

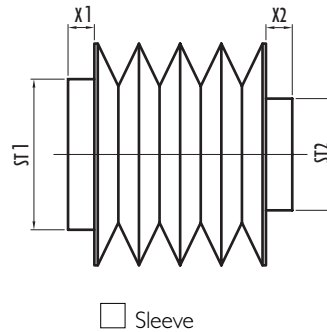
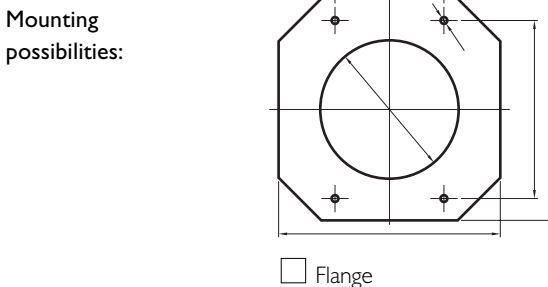
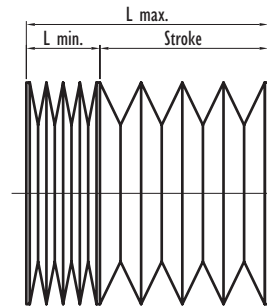
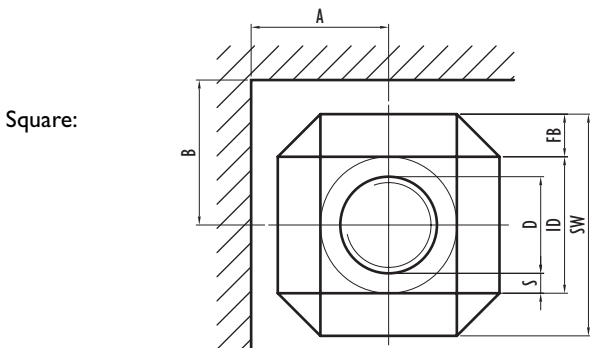

Mounting alternatives (examples):

Mounting flanges:

Steel

Stainless Steel

Plastic

Thickness in mm

left side		right side
<input type="checkbox"/>	Mounting with Flange	<input type="checkbox"/>
<input type="checkbox"/>	Mounting with Sleeve	<input type="checkbox"/>
<input type="checkbox"/>	Mounting with Strap Retainer	<input type="checkbox"/>

Bellow dimensions:

Width of bellow	SW =	mm	Diameter of sleeve	ST1 =	mm
Inner diameter	ID =	mm	Diameter of sleeve	ST2 =	mm
Fold width	FB =	mm	Extension	L max =	mm
Width of sleeve	X1 =	mm	Stroke	=	mm
Width of sleeve	X2 =	mm	Compression	L min =	mm



Mounting position: horizontal vertical Angle (if different)°

Machine dimensions:

Shaft diameter	D =	mm	Available assembly space	A =	mm
Pitch	=	mm	Available assembly space	B =	mm
			Clearance (min. mm)	S =	mm



Operating conditions:

Indoor <input type="checkbox"/>	Coolant, type	<input type="checkbox"/>	Heat <input type="checkbox"/>	Oil, type	<input type="checkbox"/>
Outdoor <input type="checkbox"/>	Corrosive <input type="checkbox"/>	<input type="checkbox"/>	Welding sparks <input type="checkbox"/>	Heavy chips <input type="checkbox"/>	<input type="checkbox"/>
Wet <input type="checkbox"/>	Abrasive <input type="checkbox"/>	<input type="checkbox"/>	Ash/Dust/Sand <input type="checkbox"/>	Chips/Swarfs <input type="checkbox"/>	<input type="checkbox"/>
Dry <input type="checkbox"/>	Magnetic <input type="checkbox"/>	<input type="checkbox"/>	Salt water <input type="checkbox"/>	Vacuum <input type="checkbox"/>	<input type="checkbox"/>

Working temperatures: °C Speed of stroke: m/Min

Internal/External pressure: bar Frequency of operation: per

Please send CAD-files via email to: j.heberer@hema-schutz.de

Inquiry-/Order-Sheet for Round-stitched Bellows



Seligenstädter Straße 82
D-63500 Seligenstadt
Phone
00 49 - (0) 61 82 - 773 - 0

Send form to fax No.
00 49 - (0) 61 82 - 7 73 35

or via Internet:
www.hema-gmbh.com

Company name: Company stamp:

Contact person:

Phone: Fax:

Quantity: E-Mail:

Delivery date: Date: Signature:

Application/Type of machine: Year of make:

Retrofit installation Split Design

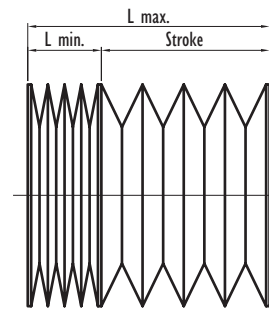
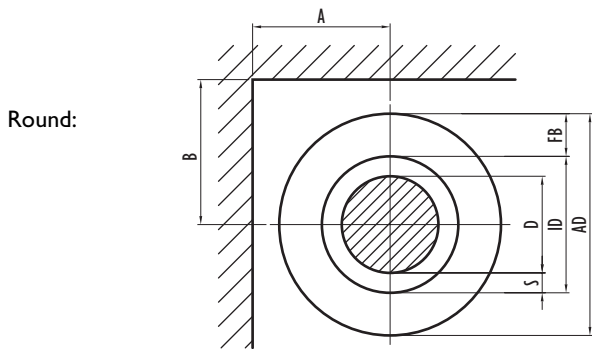

Mounting possibilities:

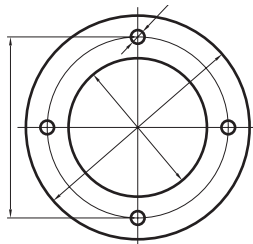

Flange

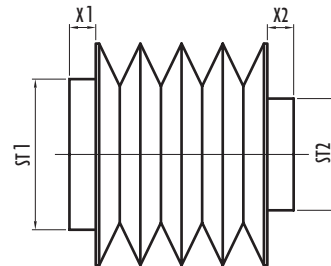

Sleeve

Mounting alternatives (examples):

Mounting flanges:

Steel

Stainless Steel

Plastic

Thickness in mm

left side right side

Mounting with Flange

Mounting with Sleeve

Mounting with Strap Retainer



Bellow dimensions:

Outer diameter	AD =	mm	Diameter of sleeve	ST1 =	mm
Inner diameter	ID =	mm	Diameter of sleeve	ST2 =	mm
Fold width	FB =	mm	Extension	L max =	mm
Width of sleeve	X1 =	mm	Stroke	=	mm
Width of sleeve	X2 =	mm	Compression	L min =	mm

Mounting position: horizontal vertical Angle (if different)°

Machine dimensions:

Shaft diameter	D =	mm	Available assembly space	A =	mm
Pitch	=	mm	Available assembly space	B =	mm
			Clearance (min. mm)	S =	mm

Operating conditions:

Indoor <input type="checkbox"/>	Coolant, type	<input type="checkbox"/>	Heat <input type="checkbox"/>	Oil, type	<input type="checkbox"/>
Outdoor <input type="checkbox"/>	Corrosive <input type="checkbox"/>	<input type="checkbox"/>	Welding sparks <input type="checkbox"/>	Heavy chips <input type="checkbox"/>	<input type="checkbox"/>
Wet <input type="checkbox"/>	Abrasive <input type="checkbox"/>	<input type="checkbox"/>	Ash/Dust/Sand <input type="checkbox"/>	Chips/Swarfs <input type="checkbox"/>	<input type="checkbox"/>
Dry <input type="checkbox"/>	Magnetic <input type="checkbox"/>	<input type="checkbox"/>	Salt water <input type="checkbox"/>	Vacuum <input type="checkbox"/>	<input type="checkbox"/>

Working temperatures: °C Speed of stroke: m/Min

Internal/External pressure: bar Frequency of operation: per

Please send CAD-files via email to: j.heberer@hema-schutz.de

Inquiry-/Order-Sheet for SPEZIAL Bellows



Seligenstädter Straße 82
D - 63500 Seligenstadt
Phone
00 49 - (0) 61 82 - 773 - 0

Send form to fax No.
00 49 - (0) 61 82 - 7 73 35

or via Internet:
www.hema-gmbh.com

Company name: Company stamp:
 Contact person:
 Phone: Fax:
 Quantity: E-Mail:
 Delivery date: Date: Signature:

1. Application/Type of machine: Year of make:

2. Required bellow cover: Soft PVC bellows Rubber disk bellows Rubber fabric bellows

Material:

2. Order designation according to data table:

3. Shape: Round Oval Rectangular Square

Type:

4. Installation situation: Vertical Horizontal Other:

5. Dimensions:
 Shaft diameter SD = mm Minimum compression L min = mm
 Inside diameter ID = mm Fold width/depth FB = mm
 Outside diameter AD = mm Fold extension FAZ = mm
 Maximum extension L max = mm Compression FZD = mm

Description of support/guide:

Remarks:

Operating conditions:
 Indoor Coolant, type Heat Oil, type
 Outdoor Corrosive Welding sparks Heavy chips
 Wet Abrasive Ash/Dust/Sand Chips/Swarfs
 Dry Magnetic Salt water Vacuum

Working temperatures: °C Speed of stroke: m/Min
 Internal/External pressure: bar Frequency of operation: per

Mounting alternatives (examples):

Mounting flanges:
 Steel
 Stainless Steel
 Plastic
 Thickness in mm

left side right side

Mounting with Flange

Mounting with Sleeve

Mounting with Strap Retainer

 Mounting with Velcro Tape

 Mounting with Snap Fastener

Please send CAD-files via email to: j.heberer@hema-schutz.de

Inquiry-/Order-Sheet for DURASPRING Spiral Springs



Seligenstädter Straße 82
D - 63500 Seligenstadt
Phone
00 49 - (0) 61 82 - 773 - 0

Send form to fax No.
00 49 - (0) 61 82 - 7 73 35

or via Internet:
www.hema-gmbh.com

Company name: Company stamp:

Contact person:

Phone: Fax:

Quantity: E-Mail:

Delivery date: Date:

Signature:

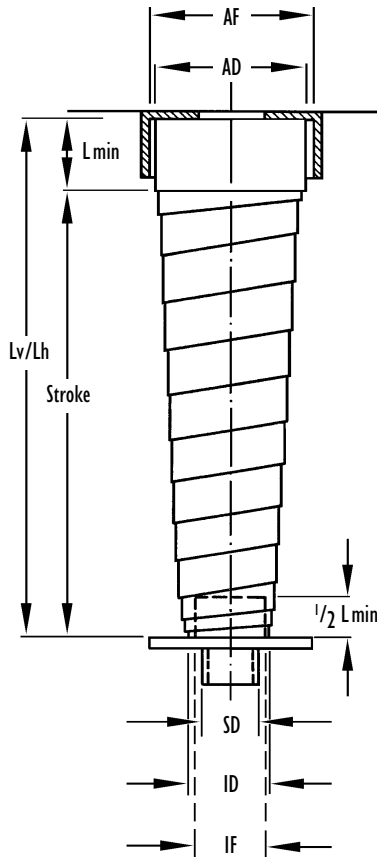

Please send CAD-files
via email to:
t.werner@hema-schutz.de

1. Application/machine:

.....

2. Year of make:

3. Required type of spiral spring:
DURASPRING silver DURASPRING blue
(Stainless steel) (Blue steel)

4. Order designation according to data table:

--	--	--	--	--	--	--	--	--	--	--	--	--	--	--	--	--	--	--

5. Please include DURASPRING Long Life Oil Spray (extra charge):
yes no

6. Mounting position:
vertical retrofit installation
horizontal

other:

7. Dimensions (check tolerances):

Shaft diameter SD = mm Extension horizontally L h = mm
 Inner diameter ID ± 1 mm = mm Extension vertically L v = mm
 Outer diameter AD ± 2 mm = mm Compression L min = mm
 (Lmin = Band width)

Support flanges (optional):

Inside diameter of centering flange AF (AD + 4 mm) = mm
 Outside diameter of centering flange IF (ID - 2 mm) = mm
 Flange with through-hole (optional) (SD + 2 mm) = mm

Remark: If flanges are used, the spindle diameter SD listed in the data tables has to be reduced by 6 mm.

Operating conditions:

Indoor <input type="checkbox"/>	Coolant, type <input type="checkbox"/>	Heat <input type="checkbox"/>	Oil, type <input type="checkbox"/>
Outdoor <input type="checkbox"/>	Corrosive <input type="checkbox"/>	Welding sparks <input type="checkbox"/>	Heavy chips <input type="checkbox"/>
Wet <input type="checkbox"/>	Abrasive <input type="checkbox"/>	Ash/Dust/Sand <input type="checkbox"/>	Chips/Swarfs <input type="checkbox"/>
Dry <input type="checkbox"/>	Magnetic <input type="checkbox"/>	Salt water <input type="checkbox"/>	Vacuum <input type="checkbox"/>

Working temperatures: °C Speed of stroke: m/Min
 Internal/External pressure: bar Frequency of operation: per

Inquiry-/Order-Sheet for Roller Covers/Apron Covers



Company name: Company stamp:

Contact person:

Phone: Fax:

Quantity: E-Mail:

Delivery date: Date: Signature:

Application/Type of machine: Year of make:

Seligenstädter Straße 82
D - 63500 Seligenstadt
Phone
00 49 - (0) 61 82 - 773 - 0

Send form to fax No.
00 49 - (0) 61 82 - 7 73 35

or via Internet:
www.hema-gmbh.com

Basic types:

Roller Roller cover Apron on idle roller Apron

Roller with brackets with apron

(design layout by HEMA)

Band material:

Stainless Steel

Regular Steel

Plastic,

Apron design:

FLEXSTAR-S FLEXPRO FLEXWALK

FLEXSTAR-C Type 1 Type 2 Type 1 Type 2

FLEXSTAR-CR Type 3 Type 4

with visual components:

Clear door

plastic material

Polycarbonate links

Operating positions:

horizontal (flat) horizontal (transverse) vertical (Roller in upper position) vertical (Roller in lower position)

Band side visible:

(please check appropriate option)

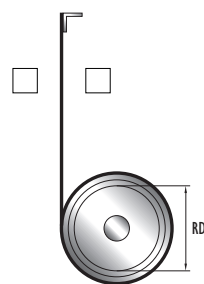

Band attachment:

F1.0

F1.1

F2.0

F2.1

Others

(Drawing/Sketch required)

Dimensions:

Length of axis X = mm Thickness of band = mm

Width of band or apron BB = mm Roller tube diameter RD = mm

Extension of band or apron AZ = mm Required tractive force of spring Z = kg/N

Operating conditions:

Indoor Coolant, type Heat Oil, type

Outdoor Corrosive Welding sparks Heavy chips

Wet Abrasive Ash/Dust/Sand Chips/Swarfs

Dry Magnetic Salt water Vacuum

Working temperatures: °C Speed of stroke: m/Min

Internal/External pressure: bar Frequency of operation: per

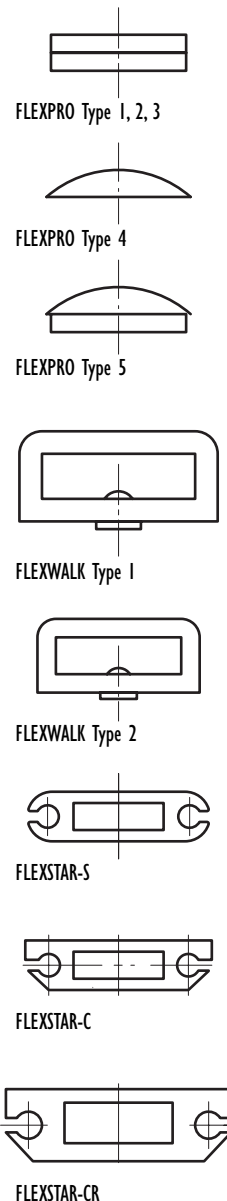

Please send CAD-files
via email to:
j.heberer@hema-schutz.de

Inquiry-/Order-Sheet for Roller Cover with Enclosure with/without Apron Cover



Seligenstädter Straße 82
D - 63500 Seligenstadt
Phone
00 49 - (0) 61 82 - 773 - 0

Send form to fax No.
00 49 - (0) 61 82 - 7 73 35

or via Internet:
www.hema-gmbh.com

Company name: Company stamp:

Contact person:

Phone: Fax:

Quantity: E-Mail:

Delivery date: Date: Signature:

Application/Type of machine: Year of make:

Material of enclosure:
Metal, primed Metal/colour Stainless steel Aluminum

Enclosure mounting position: A (choose from options 01-12 in catalogue)

Band material: Stainless Steel Regular Steel Plastic,

Apron design:
 FLEXSTAR-S FLEXPRO FLEXWALK
 FLEXSTAR-C Type 1 Type 2 Type 1 Type 2
 FLEXSTAR-CR Type 3 Type 4
 with visual components:
 Clear door Type 5
 plastic material
 Polycarbonate links

Operating positions:

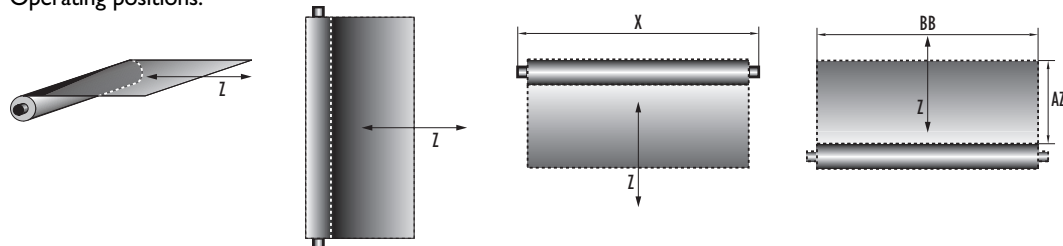

horizontal (flat) horizontal (transverse) vertical (Roller in upper position) vertical (Roller in lower position)

Bandside visible:

(please check appropriate option)

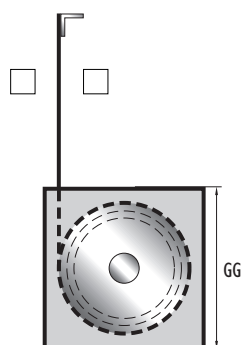

Band attachment:
 F1.0 F1.1 F2.0 F2.1

Type of wiper:
 Steel, ST
 Brushes
 PE/Plastic
 visible side to be wiped
 other side to be wiped

Dimensions:

Size of enclosure GGxGGx mm Thickness of band = mm
 Width of band or apron BB = mm Roller tube diameter AZ = mm
 Width of enclosure GB = mm Required tractive force of spring Z = kg/N

Operating conditions:

Indoor Coolant, type Heat Oil, type
 Outdoor Corrosive Welding sparks Heavy chips
 Wet Abrasive Ash/Dust/Sand Chips/Swarfs
 Dry Magnetic Salt water Vacuum

Working temperatures: °C Speed of stroke: m/Min
 Internal/External pressure: bar Frequency of operation: per

Released: 3/2006



FLEXPRO Type 1, 2, 3



FLEXPRO Type 4

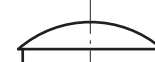

FLEXPRO Type 5

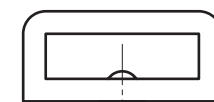

FLEXWALK Type 1

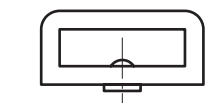

FLEXWALK Type 2

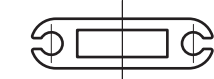

FLEXSTAR-S

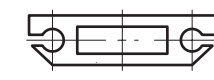

FLEXSTAR-C



FLEXSTAR-CR

Please send CAD-files via email to: j.heberer@hema-schutz.de

Inquiry-/Order-Sheet for GLADIATOR Telescopic Steel Covers (TSC) Sheet I



Seligenstädter Straße 82
 D - 63500 Seligenstadt
 Phone
 00 49 - (0) 61 82 - 773 - 0

Send form to fax No.
 00 49 - (0) 61 82 - 7 73 35

or via Internet:
www.hema-gmbh.com

Company name: Company stamp: _____

Contact person:

Phone: Fax:

Quantity: E-Mail:

Delivery date: Date: Signature:

New design Replacement/Repair:

Box(es) damaged Original maker of TSC:

Change wipers

Change Guides/Profiles

Desired TSC-Design:
 (Include drawings for linear guides, obstructions, attachments, coolant channels)

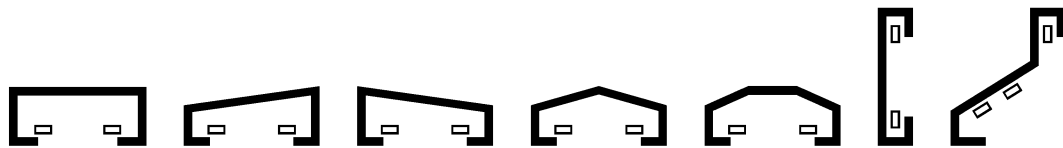

Please send CAD-files
 via email to:
t.werner@hema-schutz.de

Operating position of TSC:

Horizontal cover:

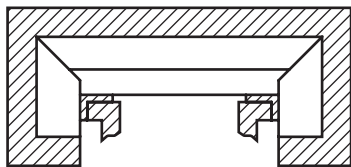

Transverse cover:

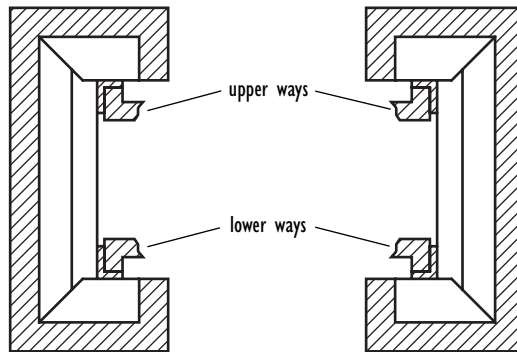

Vertical cover:

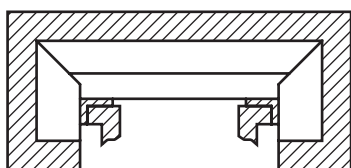

Cross-rail cover:

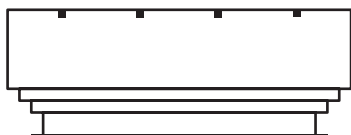
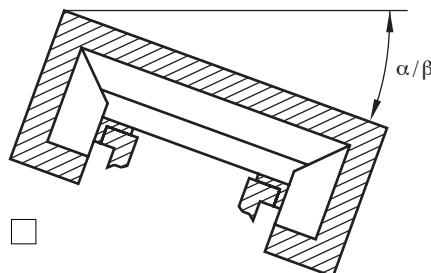

Inquiry-/Order-Sheet for GLADIATOR Telescopic Steel Covers (TSC) Sheet 2



Seligenstädter Straße 82
D - 63500 Seligenstadt
Phone
00 49 - (0) 61 82 - 773 - 0

Send form to fax No.
00 49 - (0) 61 82 - 7 73 35

or via Internet:
www.hema-gmbh.com

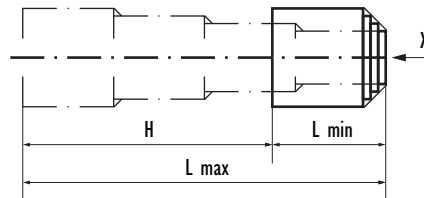
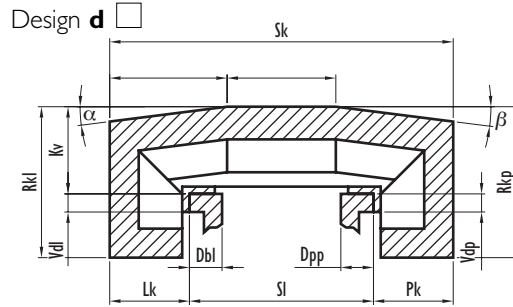
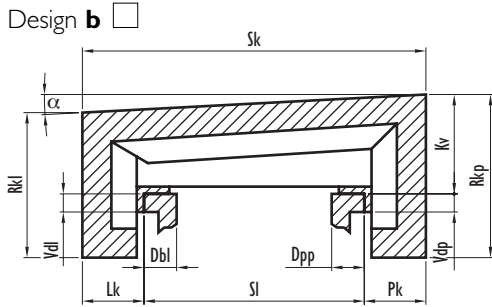
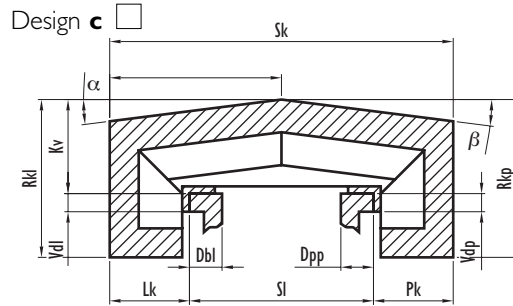
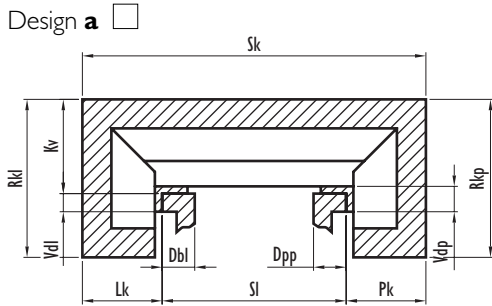

Please send CAD-files
via email to:
t.werner@hema-schutz.de

Technical Data (REQUIRED)

Stroke	H =	mm	Width of guideway left	Dbl =	mm
Compression	L min =	mm	Height of guideway left	Vdl =	mm
Extension	L max =	mm	Width of guideway right	Dpp =	mm
Linear speed	v =	m/min	Height of guideway right	Vdp =	mm
Material	Chromium-nickel-Steel	<input type="checkbox"/>	Cover bottom return left	Lk =	mm
	Regular steel	<input type="checkbox"/>	Cover bottom return right	Pk =	mm
Distance across slideways	SI =	mm	Inclination left	α =	°
Width of cover	SK =	mm	Inclination right	β =	°
Height of cover left	Rkl =	mm	Hardness of guideway > 60 HRC	yes	<input type="checkbox"/>
Height of cover right	Rkp =	mm		no	<input type="checkbox"/>
Cover height above Slideway	Kv =	mm	Fixed part of TSC	largest box	<input type="checkbox"/>
				smallest box	<input type="checkbox"/>
				no box	<input type="checkbox"/>

Supplementary Data (optional):

Acceleration	a =	m/s ²	Type of machine
Type of machining	Wet machining	<input type="checkbox"/>	Walk-on capability	yes <input type="checkbox"/> no <input type="checkbox"/>
	Dry machining	<input type="checkbox"/>	(not greater than 80 kg,	
	Mixed machining	<input type="checkbox"/>	no operation)	
			Axis	X <input type="checkbox"/> Y <input type="checkbox"/> Z <input type="checkbox"/>

Type of linear guide:

Details of label (Sketch, Content/Text):

(insert desired text)

HEMA MASCHINEN- UND APPARATESCHUTZ GMBH Sales Order-No. / Auftragsnummer		 GLADIATOR
Drawing / Zeichnung		
Part-No. / Teile-Nr.		

Inquiry-/Order-Sheet for GLADIATOR Telescopic Steel Covers (TSC) Sheet 3



Components (optional):

Wipers:

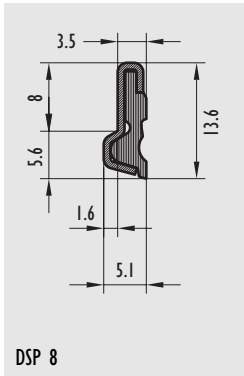

DSP 8

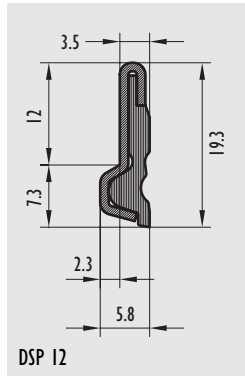

DSP 12

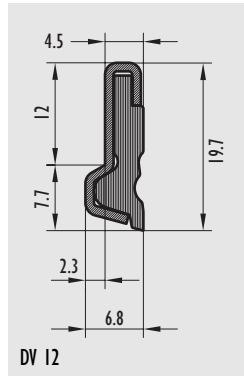

DV 12

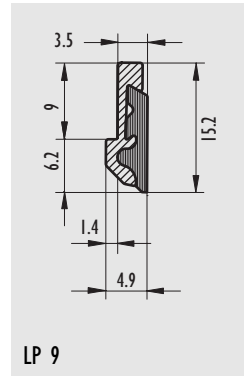

LP 9

Glidors:

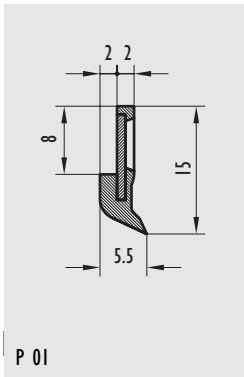

P 01

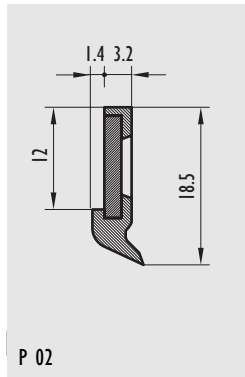

P 02

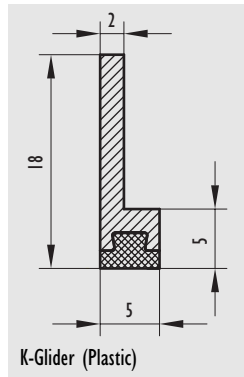

K-Glider (Plastic)

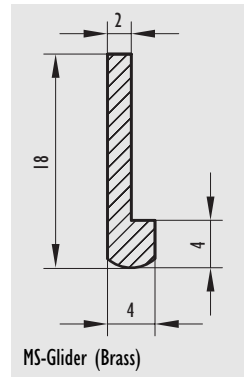

MS-Glider (Brass)

Supporting rollers:

Steel
Plastic

Assembly support:

yes
no

Coolant channel:

yes
no

Operating conditions:

Indoor <input type="checkbox"/>	Coolant, type..... <input type="checkbox"/>	Heat <input type="checkbox"/>	Oil, type..... <input type="checkbox"/>
Outdoor <input type="checkbox"/>	Corrosive <input type="checkbox"/>	Welding sparks <input type="checkbox"/>	Heavy chips <input type="checkbox"/>
Wet <input type="checkbox"/>	Abrasive <input type="checkbox"/>	Ash/Dust/Sand <input type="checkbox"/>	Chips/Swarfs <input type="checkbox"/>
Dry <input type="checkbox"/>	Magnetic <input type="checkbox"/>	Salt water <input type="checkbox"/>	Vacuum <input type="checkbox"/>

Working temperatures: °C Speed of stroke: m/Min
Internal/External pressure: bar Frequency of operation: per

Remark:

Please send CAD-files via email to: t.werner@hema-schutz.de

Inquiry-/Order-Sheet for Wiper Systems



Company name:

Company stamp:

Contact person:

Phone: Fax:

E-Mail:

Qty of sections: Length of section: 500 mm 1.000 mm mm

Delivery date: Date: Signature:

Type of wiper: Guideways Telescopic steel covers
 Linear guideways Sealing wipers for hydrostatic guides

Seligenstädter Straße 82
 D-63500 Seligenstadt
 Phone
 0049-(0)6182-773-0

Send form to fax No.
 0049-(0)6182-77335

or via Internet:
www.hema-gmbh.com

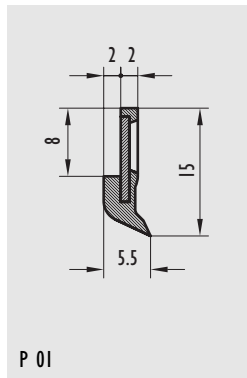

P 01

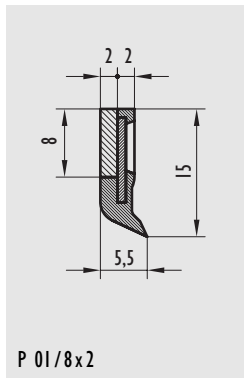

P 01/8x2

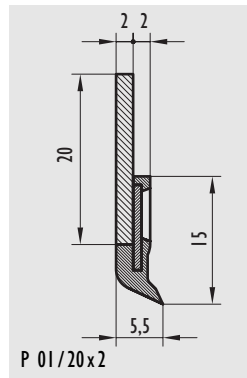

P 01/20x2

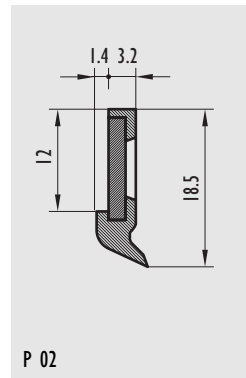

P 02

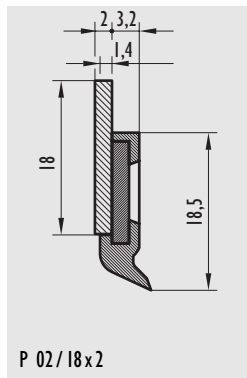

P 02/18x2

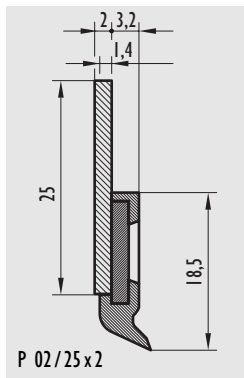

P 02/25x2

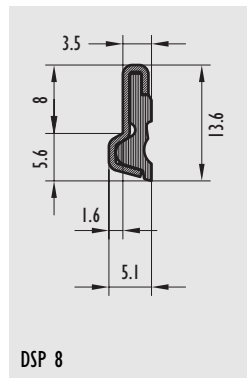

DSP 8

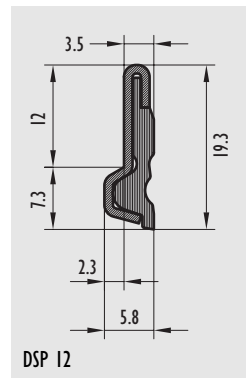

DSP 12

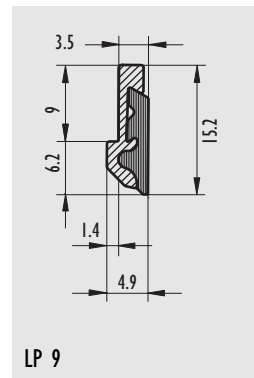

LP 9

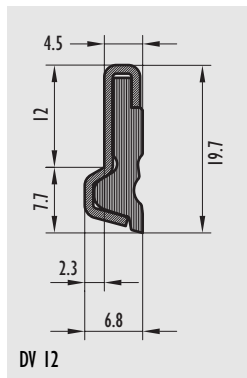

DV 12

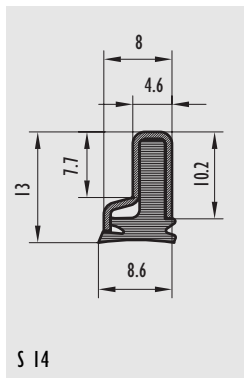

S 14

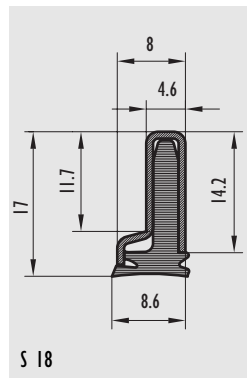

S 18

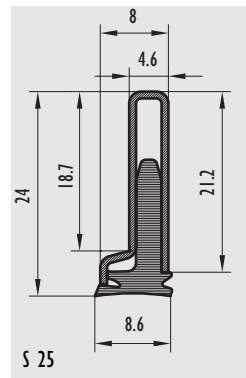

S 25

Linear guide: manufacturer: Size: Type:

Working conditions:

Released: 3/2006

Please send CAD-files
 via email to:
t.werner@hema-schutz.de

Inquiry-/Order-Sheet for VISIPOINT Spin Window Systems



Company name: Company stamp:

Contact person:

Phone: Fax:

Quantity: E-Mail:

Delivery date: Date: Signature:

VISIPOINT model range:
 VISIPOINT 180 (electrical)
 VISIPOINT 220 (electrical)
 VISIPOINT DiscAir 175/180 T
 alternatively with GOLDEN-EYE disc

Seligenstädter Straße 82
 D - 63500 Seligenstadt
 Phone
 00 49 - (0) 61 82 - 773 - 0

Send form to fax No.
 00 49 - (0) 61 82 - 7 73 35

or via Internet:
www.hema-gmbh.com

1. Application/Type of machine: Year of make:

2. Machine type:
 CNC milling machine
 CNC machining centre
 CNC lathe

3. Material of the machine window:
 New Polycarbonate Multi-layer glass Silikon coated glass Impact class
 Used Polycarbonate (A1 - C3)

4. Distance of the machine window from the spindle: in mm:

5. Types of chips:
 Small chips sharp-edged chips
 Medium sized chips Aluminum chips
 large chips Magnesium chips
 hot chips Cast iron chips

6. Chip abrasion of the machine window:
 light
 medium
 severe
 Do small chips or particles collect more intensively at certain places?
 yes no

7. Coolant quantity and coolant pressure:
 low
 average
 high
 If available, exact dimensions:
 Litres per minute state pressure in bar

8. Coolant type used:
 Designation is:
 Water soluble (semi)synthetic agent
 mineral oil
 natural oil

9. Required installation position of the VISIPOINT:
 Vertical
 Angle of inclination:°

10. Is fast fitting/dismantling of the Visiport required? yes no

11. Is the complete replacement of the machine window planned or necessary? yes no

12. Are the standard hose/cable sizes adequate? yes no

Please send CAD-files
 via email to:
m.anthes@hema-schutz.de

Inquiry-/Order-Sheet for Machine Safety Windows made of Polycarbonate



Company name: Company stamp:

Contact person:

Phone: Fax:

E-Mail:

Delivery date: Date: Signature:

Order volume per year: Order volume per batch:

Single volume Quantity volume Replacement window

Manufacturer of original machine window:

Seligenstädter Straße 82
D - 63500 Seligenstadt
Phone
00 49 - (0) 61 82 - 773 - 0

Send form to fax No.
00 49 - (0) 61 82 - 7 73 35

or via Internet:
www.hema-gmbh.com

Please add **SKETCH OR CAD-DRAWING OF YOUR MACHINE WINDOW.**

I. Application/Type of machine: Year of make:

Width of window SB = mm
Height of window SH = mm

Only required for metal frames:
Width of frame RB* = mm
Height of frame RH* = mm
(Specify mounting holes for frame)

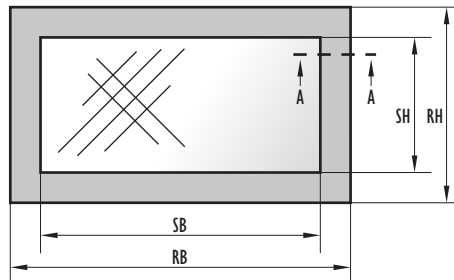

* optional information

2. Thickness of window frame = mm 3. required/current thickness = mm of Polycarbonate* (4 to 19 mm)

4. Thickness of glass*: = mm Single-layer glass* (optional) Multi-layer glass* (Standard)

5. Attachment (frame is optional)*: Stainless Steel frame Aluminum frame Glass/Polycarbonate graded

6. Frame types (optional)* (cross-section A-A):

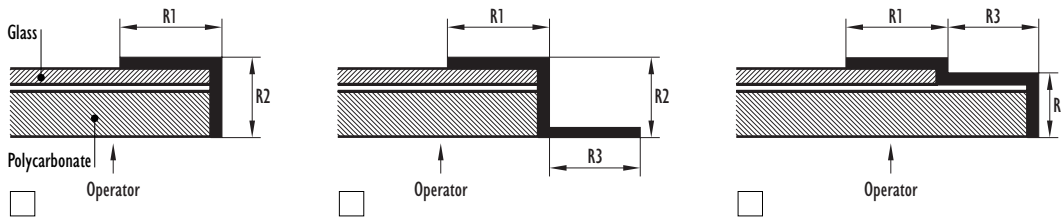

7. Frame dimensions: R1 = mm R2 = mm R3 = mm

8. Required safety impact resistance class: (according to DIN EN 12415)
 A1 A2 A3
 B1 B2 B3
 C1 C2 C3

To determine the required impact class, please provide the following data for your machine:

1.) Turning centre 2.) Milling centre

Maximum speed of spindle: rpm Maximum speed of spindle: rpm

Diameter of largest chuck: mm Diameter of largest tool: mm

Weight of largest chuck: kg

Please send CAD-files via email to: j.heberer@hema-schutz.de

Inquiry-/Order-Sheet for EAGLEVISION - Integrated Spin Window Systems



Company name: Company stamp:
 Contact person:
 Phone: Fax:
 Quantity: E-Mail:
 Delivery date: Date: Signature:

Seligenstädter Straße 82
 D - 63500 Seligenstadt
 Phone
 00 49 - (0) 61 82 - 773 - 0

Send form to fax No.
 00 49 - (0) 61 82 - 7 73 35

or via Internet:
www.hema-gmbh.com

EAGLEVISION model range:
 electric versions: EAGLEVISION ELEKTRA 280 hydraulic versions: EAGLEVISION HYDRA 280

EAGLEVISION will be delivered preinstalled into a machine safety window, therefore we need the **PRECISE DATA OF THE MACHINE SAFETY WINDOW!**
 (Please use also the Inquiry-/Order-Sheet for Machine Safety Windows)

1. Application/Type of machine: Year of make:

2. Required safety impact protection class for machine window:
 (according to DIN EN 12415) A1 A2 A3
 B1 B2 B3
 C1 C2 C3

3. Is your machine window larger than 400 x 400 mm? yes no

4. What is the coolant pump pressure? (only required for Hydra) bar

5. Do you use a door wiper on the inside of the machine door? yes no

6. The door of the machining centre opens to the outside inside left right

7. Total space needed for machine window construction: mm

8. Distance of the machine window from the spindle: mm

9. Type of chips:
 Small chips sharp-edged chips
 Medium sized chips hot chips
 Large chips Aluminum chips
 Magnesium chips
 cast iron chips

10. Chip abrasion of the machine window:
 light Do small chips or particles collect more intensively at certain places?
 medium yes no
 severe

11. Coolant quantity and coolant pressure:
 low If available, exact amount:
 average Litres per minute
 high state pressure in bar

12. Coolant type used:
 Designation is: Water soluble mineral oil
 natural oil
 (semi)synthetic agent

Please send CAD-files
 via email to:
info@hema-schutz.de